

Since 1968

COMMAX
SmartHome & Security

User Manual

DOOR PHONE DP-LA01M,LA01S



www.commax.com

COMMAX Co.,Ltd.



- Thank you for purchasing COMMAX products.
- Please carefully read this User's Guide (in particular, precautions for safety) before using a product and follow instructions to use a product exactly.
- The company is not responsible for any safety accidents caused by abnormal operation of the product.



1. Warnings and Caution

To prevent fire or shock hazard, do not expose the unit to rain or moisture.



This symbol is intended to alert the user to the presence of uninsulated **"dangerous Voltage"** within the product's enclosure that may be of sufficient magnitude to constitute a risk of electric shock to persons.



This symbol is intended to alert the user to the presence of important operating and maintenance (servicing) instructions in the literature accompanying the appliance.



caution

Risk of electric shock
do not open



CAUTION : To reduce the risk of electric shock, do not remove cover(or back) no user-serviceable part inside refer servicing to qualified service personnel.



2. Overview

DP-LA01M

DP-LA01S

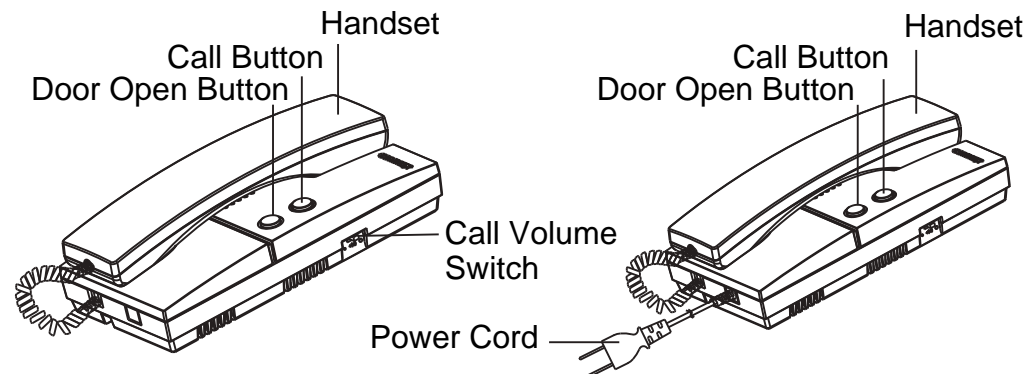

3. Operation

[Communication with the door station]

1. When a visitor presses the calling button, both handset Master and Slave ring.
(Volume can be adjusted by the switch on the side of handset: only DP-LA01M)
2. Pick up one handset between Master and Slave and start the communication.
3. Check the visitor first and push the door open button to open the door.



3. Operation

[Communication between handset]

DP-LA01M ↔ **DP-LA01S**

1. Pick up the handset to call another handset.
(The handset will be called while the button is being pushed.)
2. When other party gets the phone, the conversation begins.
3. If a visitor presses the call button while the handset is being used, the handset will ring
4. Hang up the phone to finish the conversation between handsets and pick it up again to begin the conversation with the visitor.
(If you pick up the handset, it will be connected to the door unit automatically.)



4. Wiring

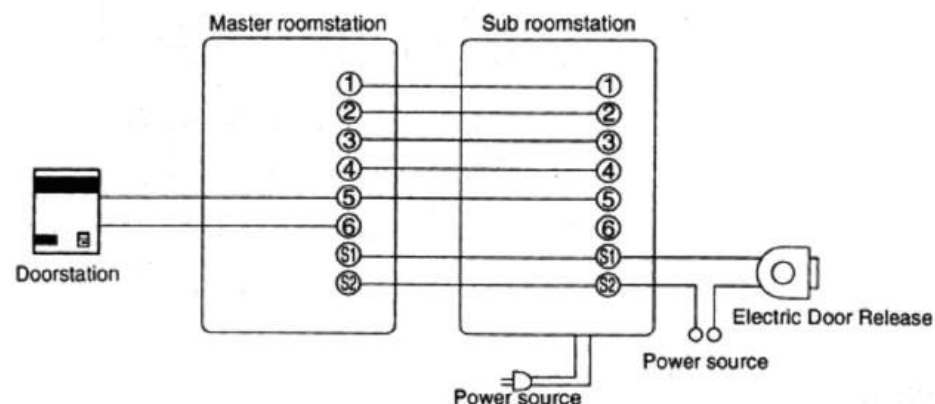

5. Specifications

POWER SOURCE	AC 110/120/220/230/240V,50-60Hz
OUTPUT POWER	Call : High 400mW
	Low 100mW
	Talk : 70mW
DISTANCE	30m, 0.65ø(When talking to Master)
	50m, 0.65ø(When talking to door station)
DIMENSION	DP-LA01M :208(D) X 98(W) X 60(H)mm
	DP-LA01S :208(D) X 98(W) X 65(H)mm
WEIGHT	DP-LA01M : 510g
	DP-LA01S : 675g

PORTERO ELECTRICO "COMMAX" MOD. DR-2K



ESPECIFICACIONES PANEL DR-2K :

- **Alimentación:** 9V DC (Provista desde el teléfono DP-2S)
- **Cableado:** 2 hilos
- **Instalación** Exterior
- **Tipo de montaje** Montaje superficial
- **Dimensiones:** 96X128X30mm
- **Distancia máxima cableado:** 100m (0.65Φ), 150m (0.8Φ)
- **Temperatura:** -10(°C) ~50(°C)

CABLEADO

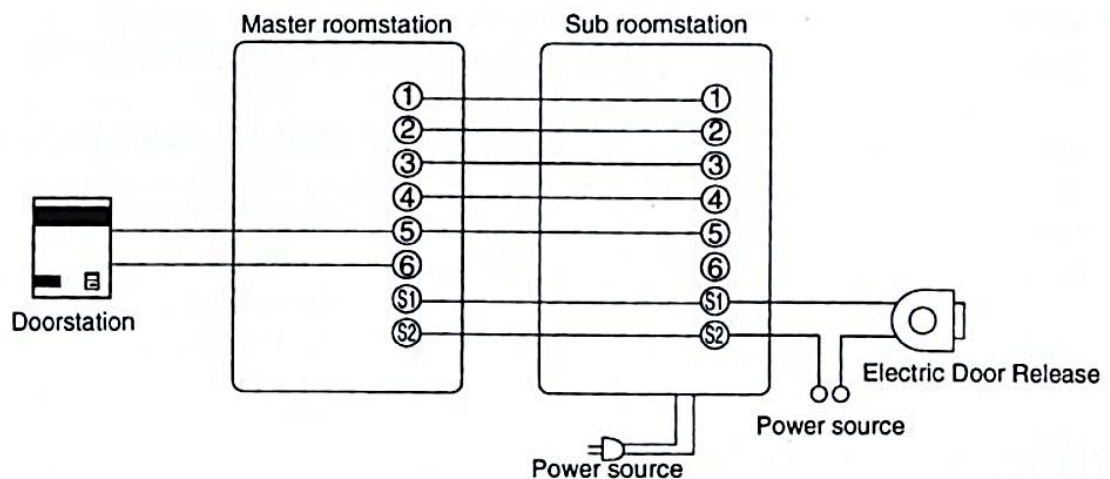

DIMENSIONES PANEL DR-2K :

96mm Ancho X 128mm Alto X 30mm Profundidad

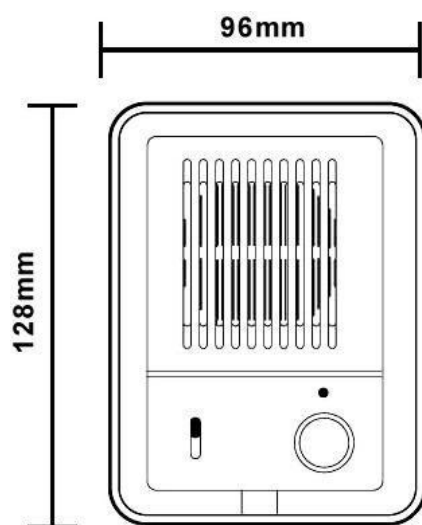

INSTALACION PANEL DR-2K

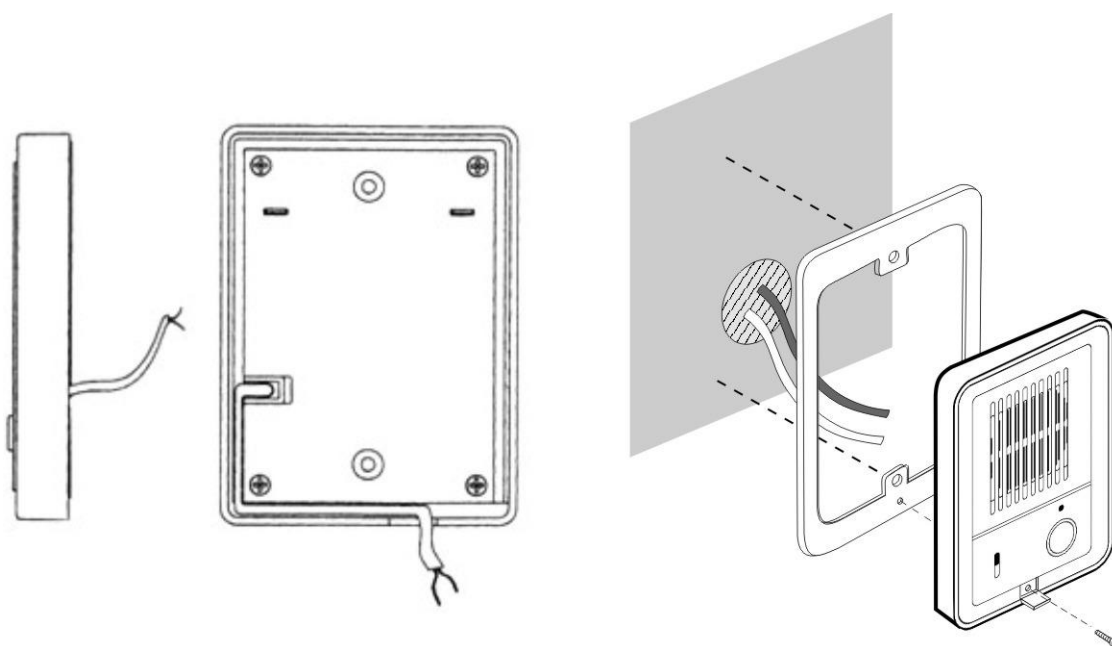

ir electronics®